



# DODGE

## SuperRail Mounting Kit

### #0848



---

# Installation Instructions

---

## SPECIFICATIONS

- Fits 2011-2012 Dodge 2500 & 3500 except 2WD 3500 w/ overload springs
  - Hitch is located 1-3/8" ahead of the axle
  - No-drill application
- Custom Mounting Bracket Kit (*Bracket & Hardware*) #0858

# TABLE OF CONTENTS

PLATE ASSEMBLY.....	3
#1200 HITCH ASSEMBLY — EXPLODED VIEW .....	4
#1200 HITCH ASSEMBLY & PARTS LIST .....	5
#0800 HITCH ASSEMBLY — EXPLODED VIEW .....	6
#0800 HITCH ASSEMBLY & PARTS LIST .....	7
MOUNTING KIT PARTS LIST .....	8
BASE RAIL ASSEMBLY PARTS LIST .....	9
TRUCK PREPARATION.....	10
MARKING THE TRUCK BED FOR DRILLING.....	10
LAYOUT METHOD .....	10
TEMPLATE METHOD .....	11
INSTALLATION .....	12
PART 1 — BRACKET PLACEMENT & BED HOLE LOCATIONS.....	12
PART 2: DRILLING THE BED & BRACKET INSTALLATION .....	14
PART 3: HITCH ALIGNMENT.....	15
PART 4: FINAL INSTALLATION PROCEDURES .....	15

## PLATE ASSEMBLY

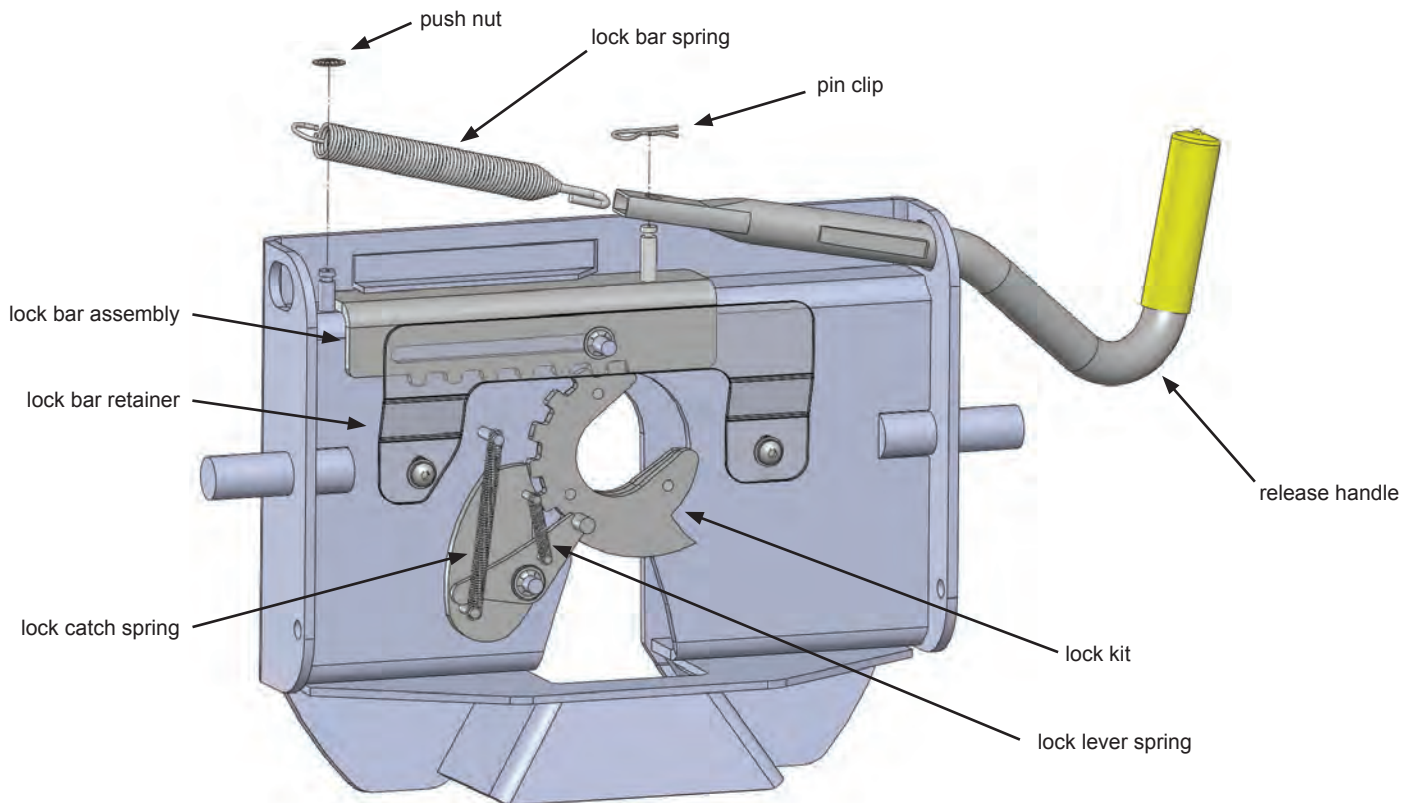

1. Remove the Fifth Wheel Plate from the Rocker Arm and place it upside down on a smooth, clean surface.
2. Insert the Release Handle into the obround hole of the plate as seen above.
3. The Lock Bar Spring must be placed inside the handle prior to placing the handle down over the pin of the Lock Bar Assembly, "catching" the hook inside the handle around the pin.
4. Push the handle and spring assembly down past the groove in the pin of the Lock Bar Assembly, and place the Pin Clip in the groove of the pin to fasten.
5. Grip the body of the spring and stretch it far enough over the opposite pin (welded to the plate) and push it down past the groove.
6. Install the Push Nut to secure the Lock Bar Spring onto the welded pin.

As a PullRite fifth wheel hitch owner, it is important for you to study and manually operate the Fifth Wheel Plate and Release Handle to better understand the locking action. A better working knowledge of the plate will help prevent accidental dropping of your trailer due to incorrect hitching.

Also, it is imperative that you study and adhere to the Maintenance procedures provided in the Owners Manual. If you did not receive one upon purchase, please contact PullRite or visit us on the web at [www.pullrite.com](http://www.pullrite.com).

# #1200 HITCH ASSEMBLY — EXPLODED VIEW

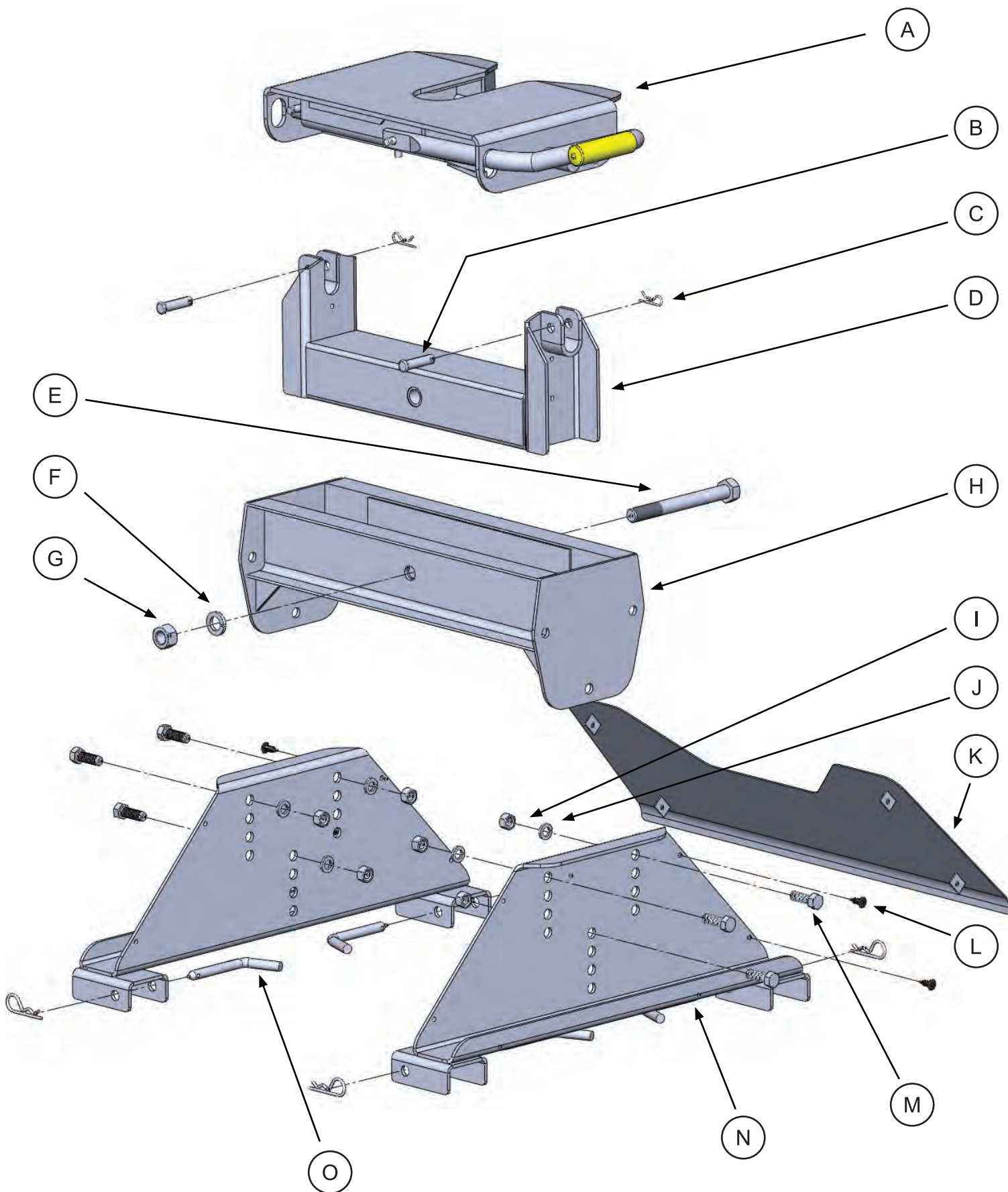

## #1200 HITCH ASSEMBLY & PARTS LIST

1. Check part quantities using the Parts List.
2. Arrange the Base Rails parallel to each other and attach the Base Sides using the four 1/2" Base Rail Pins and four Pin Clips.
3. Remove the 3/4" x 7" Rocker Arm Pivot Bolt from the Rocker Arm and Crossmember. The Rocker Arm is shipped upside down in the Crossmember for better packaging and will need to be removed and reinstalled right side up in the Crossmember. Tighten the 3/4" x 7" Rocker Arm Pivot Bolt only enough so that the Rocker Arm will rotate stiffly. Lubricate the Rocker Arm Pivot Bolt with heavy grease before installing.
4. Fasten the Crossmember and Base Sides together using six each of the 1/2"-13 x 1 1/2" Bolts, 1/2" Lock Washers, and 1/2"-13 Hex Nuts. This hitch has four height settings; make certain to adjust the Rocker Arm Crossmember according to your truck and vehicle so you have a minimum of 6" between the top of the truck's bed sides and the bottom of your trailer. Attach the Base Cover Assembly to the Base Sides using the four Plastic Barbed Fasteners provided. The tabs welded to the Base Cover Assembly fit on the inside of the Base Sides. Tighten bolts to 75 foot pounds.

### HITCH ASSEMBLY PARTS LIST

item	description	part no.	qty.	material
A	FIFTH WHEEL PLATE	3601	1	
B	CLEVIS PIN	98410111	2	
C	PIN CLIP	98410127	6	#3 PIN CLIP
D	ROCKER ARM	0802	1	
E	ROCKER ARM PIVOT BOLT	98010147	1	
F	ROCKER ARM LOCK WASHER	98200124	1	3/4" SPLIT LOCK WASHER
G	ROCKER ARM HEX NUT	98150131	1	3/4" - 10 HEX NUT
H	ROCKER ARM CROSSMEMBER	1202	1	
I	1/2" HEX NUT	98150153	6	1/2" - 13 HEX NUT
J	1/2" LOCK WASHER	98200142	6	1/2" LOCKWASHER
K	BASE COVER	120302	1	
L	PLASTIC BARBED FASTENER	98410560	4	
M	1/2" X 1-1/2" FRAME BOLT	98010167	6	1/2" - 13 X 1-1/2" HHCS GRD 5
N	BASE SIDE	120301	2	
O	BASE RAIL PINS	08060001	4	1/2" ROUND



# #0800 HITCH ASSEMBLY — EXPLODED VIEW

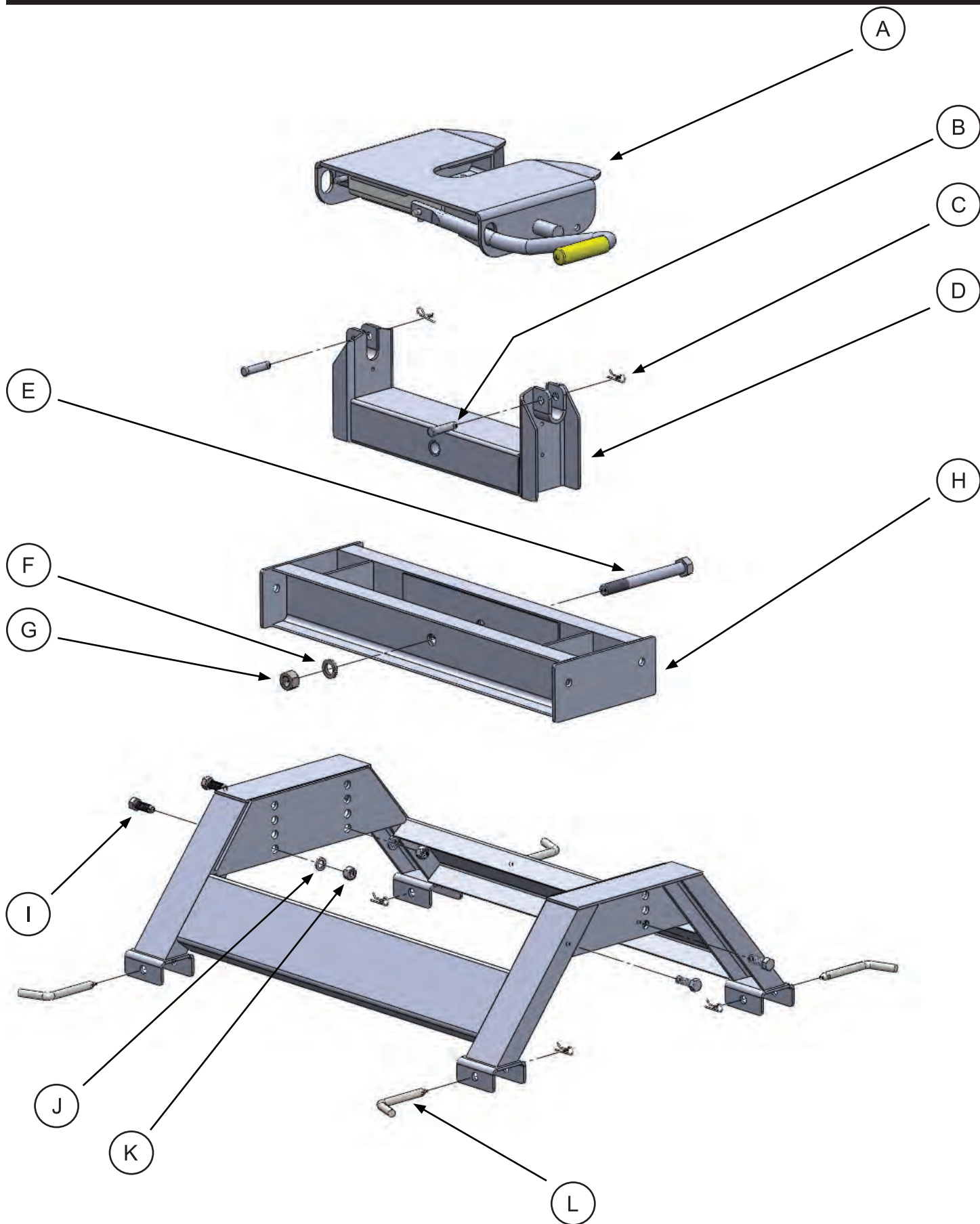

## #0800 HITCH ASSEMBLY & PARTS LIST

If the hitch type to be installed is a 20,500 (Part #0800), there is no assembly required except to attach the Base Rails to the base feet of the hitch Base using the four 1/2" Base Rail Pins and four Pin Clips.

This hitch has four height settings; make certain to adjust the Rocker Arm Crossmember according to your truck and vehicle so you have a minimum of 6" between the top of the truck's bed sides and the bottom of your trailer. Be sure to torque all four 1/2" x 1 1/2" Bolts to 75 foot pounds.

HITCH ASSEMBLY PARTS LIST				
item	description	part no.	qty.	material
A	FIFTH WHEEL PLATE	3601	1	
B	CLEVIS PIN	98410111	2	
C	PIN CLIP	98410127	6	#3 PIN CLIP
D	ROCKER ARM	0802	1	
E	ROCKER ARM PIVOT BOLT	98010147	1	
F	ROCKER ARM LOCK WASHER	98200124	1	3/4" SPLIT LOCK WASHER
G	ROCKER ARM HEX NUT	98150131	1	3/4" - 10 HEX NUT
H	ROCKER ARM CROSSMEMBER	0803	1	
I	1/2" BASE BOLT	98010167	4	1/2" - 13 X 1-1/2" HHCS GRD 5
J	1/2" BASE LOCK WASHER	98200142	4	
K	1/2" BASE HEX NUT	98150153	4	1/2" - 13
L	BASE RAIL PINS	08060001	4	1/2" ROUND

# MOUNTING KIT PARTS LIST

## #0858 — MOUNTING BRACKET KIT

item	description	part no.	qty.	material
A	REAR PASSENGER SIDE BRACKET	085804	1	
B	FRONT PASSENGER SIDE BRACKET	085402	1	
C	REAR DRIVER SIDE BRACKET	085803	1	
D	FRONT DRIVER SIDE BRACKET	085401	1	
E	5/8" FLANGE NUT	98150200	2	5/8"-11 SERRATED FLANGE NUT
F	5/8" HOLE BACKUP PLATE	08580307	2	5/8" HOLE BACKUP PLATE
G	1/2" BRACKET BOLT	98010167	2	1/2"-13 X 1-1/2" GRD 5
H	1/2" LOCKWASHER	98200142	4	1/2" LOCKWASHER
I	5/8" BRACKET BOLT	98010234	2	5/8"-11 X 4-1/2" GRD 5
J	VERTICAL BOLT PLATE	08580308	2	VERTICAL BOLT PLATE
K	REAR FRAME SPACER	33180701	2	
L	1/2" FRAME BOLT	98010214	2	1/2"-13 X 7-1/2" GRD 5 HEX CAP SCREW
M	CENTER HOLE BACKUP PLATE	05070302	2	1/2" CENTER HOLE BACKUP PLATE
N	1/2" FLANGE NUT	98150201	4	1/2"-13 SERRATED FLANGE NUT
O	ANTI-ROTATION BOLT	082105	4	1/2" ANTI-ROTATION BOLT
P	1/2" BOLT LEADER	98340197	1	1/2" BOLT LEADER

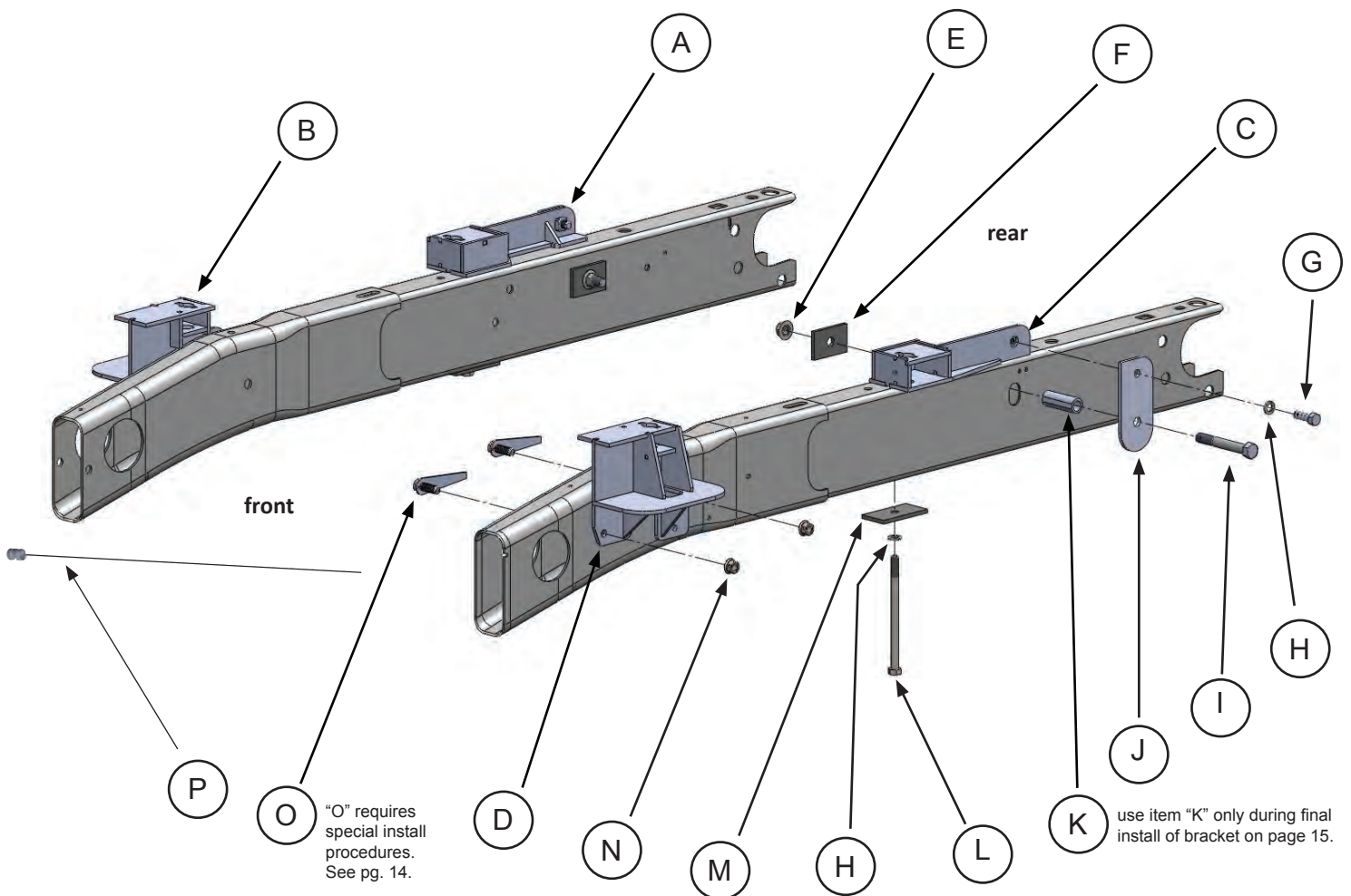



# BASE RAIL ASSEMBLY PARTS LIST

## #084003 — BASE RAIL HARDWARE KIT

item	description	part no.	qty.	material
A	BASE RAIL PIN	08060001	4	BASE RAIL PIN
B	PIN CLIP	98410127	4	#3 COTTER PIN
C	BASE RAIL BOLT	98050140	8	3/8"-16 X 3 1/2" CARRIAGE GRD. 5
D	BASE RAIL FLAT WASHER	98250175	8	3/8" FLAT WASHER
E	BASE RAIL LOCK WASHER	98200151	8	3/8" LOCK WASHER
F	BASE RAIL HEX NUT	98150211	8	3/8" - 16 HEX NUT
G	BASE RAIL MOUNTING POSTS	330701	4	

## #0840 — BASE RAIL ASSEMBLY KIT

item	description	part no.	qty.	material
H	BASE RAIL EXTENSION	084002	4	
I	BASE RAIL	084001	2	

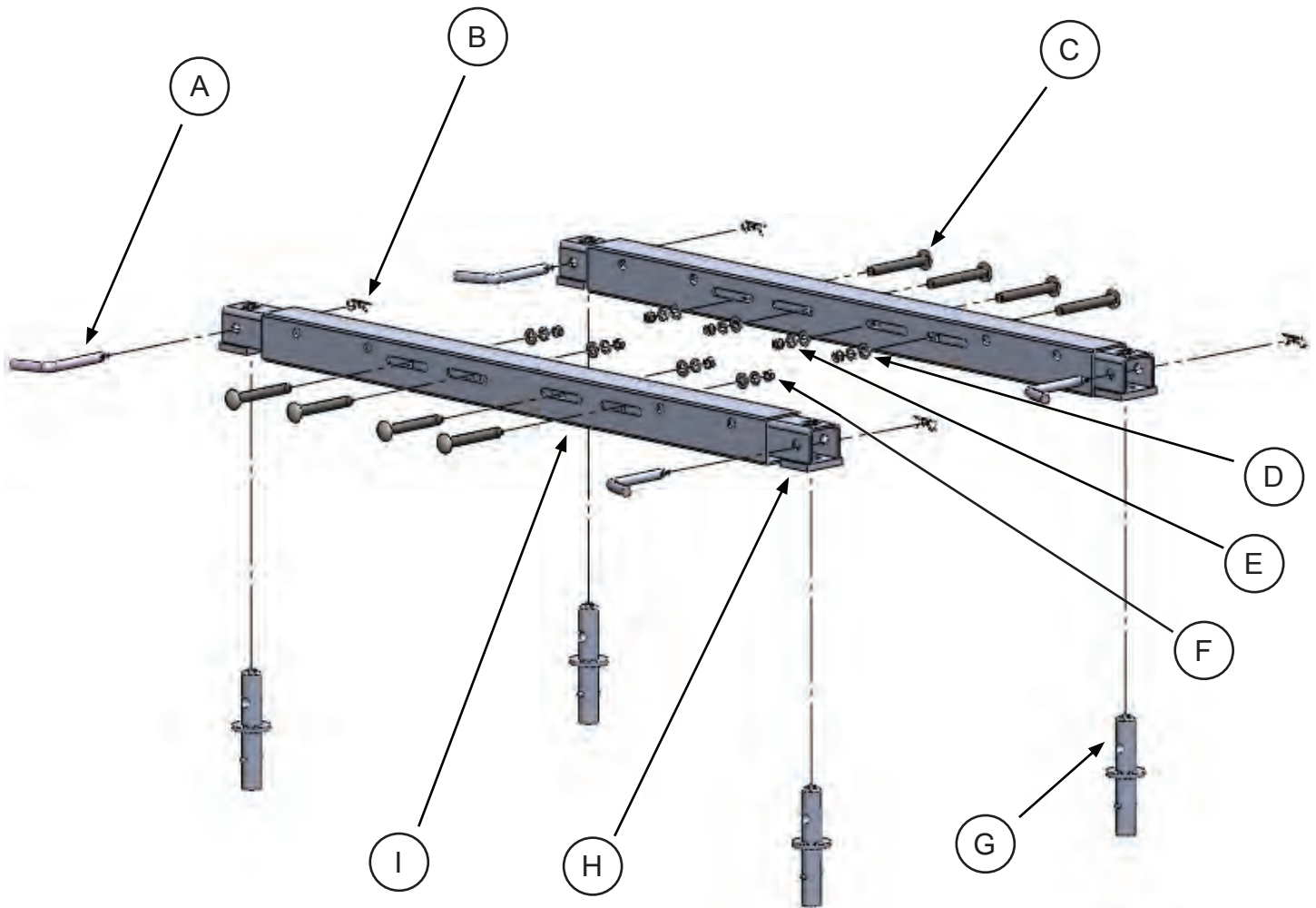

# TRUCK PREPARATION

1. Block vehicle wheels. Some vehicles may require you to raise the rear of the truck to install the mounting brackets on the truck frame.
2. Remove the emergency brake cable bracket located in the driver side wheel well (replace after installing the hitch mounting brackets).
3. If the truck is a two wheel drive, remove the axle jounce bumper located just above the axle on the bottom of the frame (replace after the hitch is installed). If the truck is a two wheel Dodge 3500 with overload brackets, this mounting system will not work.
4. If your installation is for a six foot bed truck with overload brackets, you must trim the cross sill extensions located under the front bed cross sill even with the bottom of the main cross sill as they will interfere with the installation of the Front Mounting Bracket.
5. Remove the spare tire and set aside.
6. You may wish to remove the wheels to give yourself greater working room.

# MARKING THE TRUCK BED FOR DRILLING

## LAYOUT METHOD

If you purchased an installation template, please proceed to "TEMPLATE METHOD". *Templates are sold separately.*

1. Referencing "Truck Bed Dimension Table" below, measure and mark from the back of the bed forward, the values for "A" and "B". Do this at any point on both sides of the bed.
2. Draw a line across the bed from mark to mark.
3. Find the centerline of the bed.
4. Draw a line down the middle of the bed from front-to-rear.
5. Center the measurement of "C" across the centerline at the front-most line you made in step 2 and mark the measurement on each side (parallel to the centerline).
6. Center the measurement of "D" for the rear most line made in step 2, and again mark the measurement on each side (parallel to the centerline). This will locate the 4 drill holes.

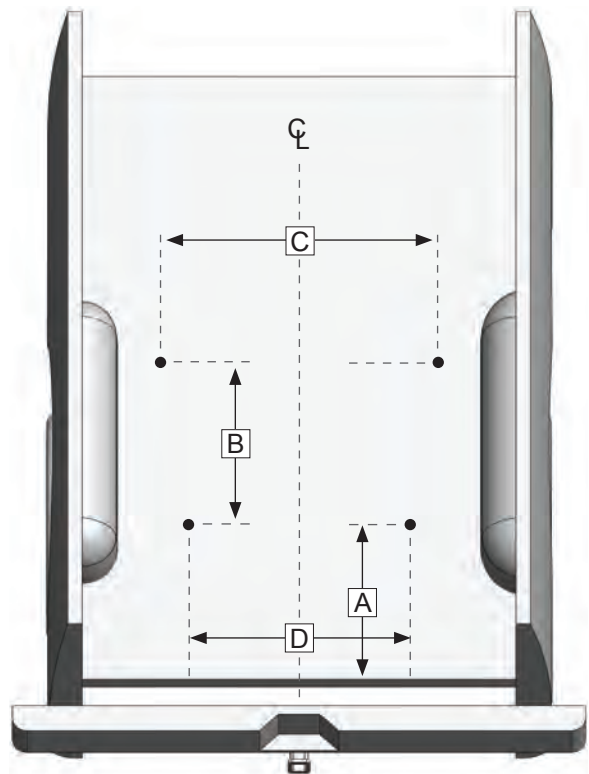

**TRUCK BED DIMENSION TABLE**

BED LENGTH	LAYOUT METHOD				TEMPLATE METHOD	
	"A"	"B"	"C"	"D"	"X"	Template part#
6 ft.	29-11/16"	24"	42-7/16"	41-13/32"	28-11/16"	08540000
8 ft.	31-9/16"	24"	42-7/16"	41-13/32"	30-9/16"	08540000

## TEMPLATE METHOD

1. Lay the template in the truck bed, centering it from side-to-side, and parallel to the end of the truck bed using the dimension "X" listed in "Truck Bed Dimension Table."
2. Mark the 4 holes, while making sure the template does not move.

**NOTE:** The *TEMPLATE* should be orientated as shown in the drawing to the left. Notice that the spacing of the forward and rearward facing holes may be different, and can be used to determine the correct orientation of the template. Item "C" in the Truck Bed Dimension Table on page 10 shows the forward facing dimension, and Item "D", the rearward facing dimension. Note also, the information etched into the template — the direction of the cab, the template number and the revision date.

**INSTALLATION TIP:** The template has a tendency to move when placed on the slick paint of new truck beds, and it may be helpful to place a small piece of NON-SKID matting, such as "SCOOT-GARD"™ or simply use duct tape on each corner to help keep the template from moving.

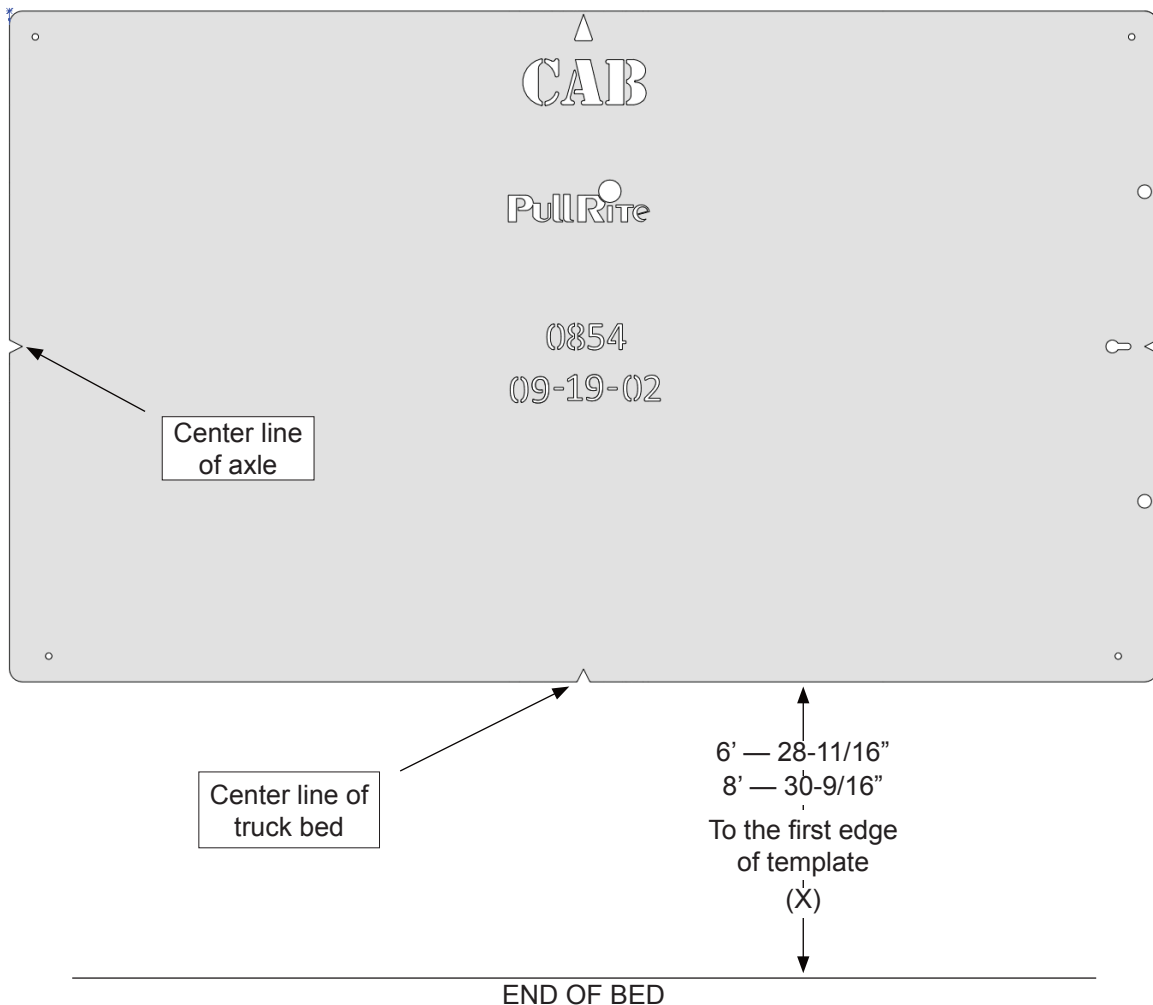

# INSTALLATION

## PART 1 — BRACKET PLACEMENT & BED HOLE LOCATIONS

Since most truck beds are not installed square to the frame or are the same distance from the back of the cab, the installer will need to make sure the bed holes line up properly with the center of each mounting post hole.

The basic steps in this section are as follows:

- Layout the bed holes
- Drill the first pilot hole in the bed
- Check centering using the tape method
- Adjust the bed hole layout if necessary
- Drill the second pilot hole and check centering to ensure bed hole locations are square to the frame; adjust as needed
- Drill remaining pilot holes in the bed; check centering
- Drill truck frame, if necessary

### Detailed Installation Instructions

1. Use transparent tape to cover the mounting post hole on the top of each mounting bracket (when the pilot hole is drilled through the bed, the tape will be pierced by the small drill; it should be positioned in the center of the 1" mounting post hole).
2. This is a no-drill installation, the brackets will use existing holes in the frame drilled by the manufacturer, note drawings for existing holes and fastening methods.
3. Position all mounting brackets on the frame and clamp or fasten in place to determine if your bed layout marks are square to the frame, making sure the brackets are tight against the frame (some mounting brackets may have a slight warp due to the metal characteristics during the welding process). Do not tighten fasteners permanently, you will be removing the brackets to drill the 2" holes through the bed.

**INSTALLATION TIP:** Front mounting brackets clamp in place. The rear mounting brackets, due to a lack of space between the frame of the truck and the side body of the truck, are placed on the top of the truck frame by inserting it vertically between the side of the truck and the frame and "rolling" it onto the top of the truck frame (see illustration below). Attach the vertical bolt plate {J} to the rear mounting bracket using the bolt provided {G}. Insert the 7-1/2" Frame Bolt {L} and the center hole backup plate {M} to the existing hole located on the underside of the frame. Hand tighten the bolt into the welded nut inside the mounting bracket post holder.

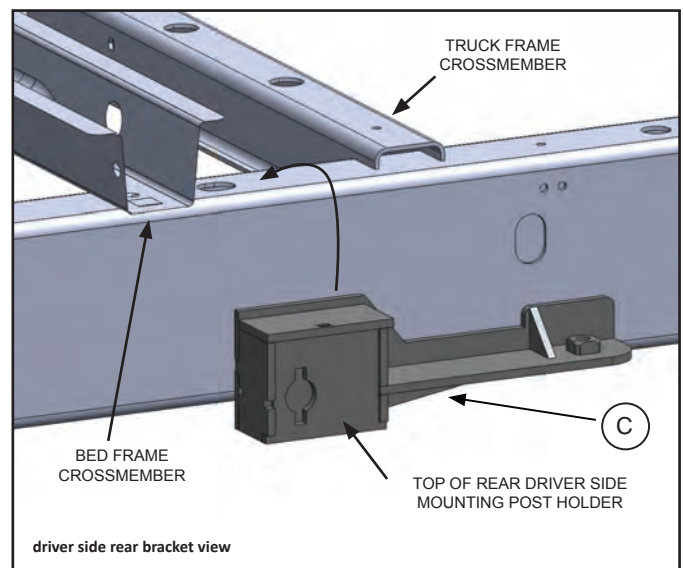
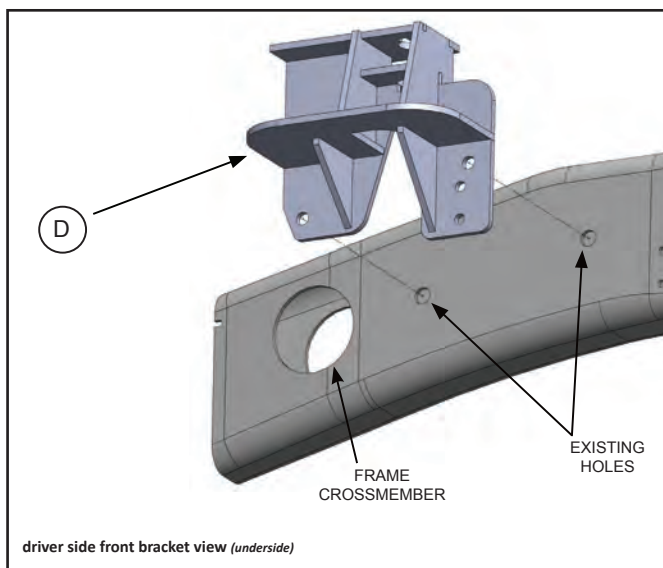

# INSTALLATION

**WARNING:** Prior to drilling any holes, be sure to check the inside of the frame to guard against drilling into the fuel tank, wiring, brake lines or fuel module.

4. Drill the first 1/16" pilot hole through the truck bed over the front hole on the driver side where you made the mark during the "Marking Bed for Drilling" on page 10. The bit should come down through the 1" mounting post hole, piercing the transparent tape, aiding the centering of the bracket front-to-rear and side-to-side.
5. If the pilot hole is off center to the 1" mounting post hole, remember to adjust all the pilot hole locations accordingly.

**NOTE:** Some truck beds are not installed square on their frame by the manufacturer. To ensure your pilot holes are aligned properly, it is important that you use the measurements provided only as a starting point and make adjustments as needed. Once you have the first pilot hole centered, you will use this hole as a point of reference for all remaining pilot hole adjustments. If you are using the Template Method, simply use the properly drilled hole as a pivot point to square the remaining holes to the frame. If you are using the Layout Method, you may accomplish the same thing by using a framing square and straight edge.

6. Remove the mounting brackets (and transparent tape) before drilling the 2" holes.

**WARNING:** Before proceeding to "Part 2, "Drilling the Bed..." you must verify that each pilot hole is centered over the 1" mounting post hole on each bracket before the 2" mounting post holes are drilled through the bed.

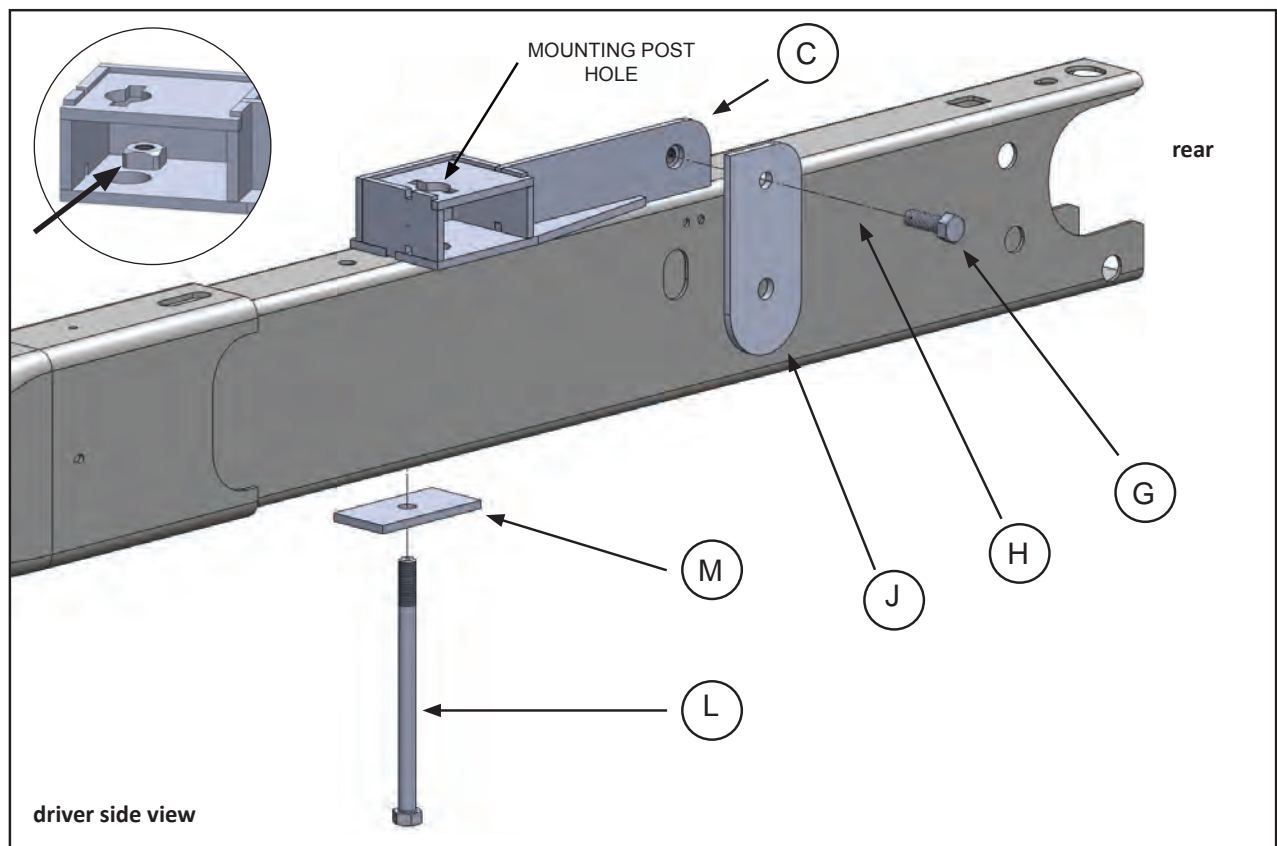



# INSTALLATION

## PART 2: DRILLING THE BED & BRACKET INSTALLATION

1. Remove the mounting brackets, use a 2" hole saw centered over the 1/16" pilot hole and cut the bed for the mounting posts.
2. De-bur inside the holes and use a paint stick to touch up the edges.
3. Reinstall the mounting bracket flush to the frame by using a clamp for the Front Mounting Brackets and fasteners for the Rear Mounting Brackets.
4. Install the mounting posts through the bed into the mounting bracket post holders. Rotate the posts a quarter turn (see the illustration to the right). Four posts are required for installation.

**NOTE:** Vehicles using plastic bed liners may require taller mounting posts (part# 330705) to seat properly into the post holders.

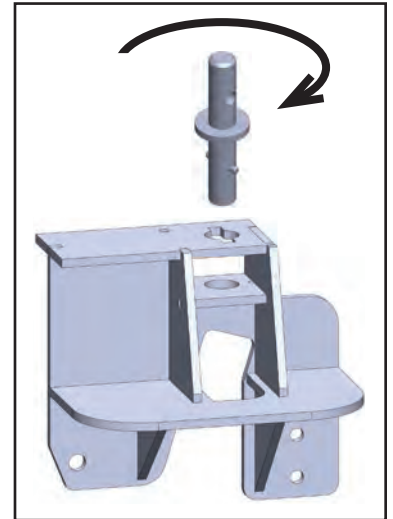

## FRONT MOUNTING BRACKET INSTALLATION

1. The front mounting brackets require anti-rotation bolts {O} to be "fished" through the frame.
2. With the bracket clamped in place, thread a long fish wire (*not provided*) through the forward 1/2" hole in the bracket and frame, threading the wire rearward to the end of the frame.
3. Once the wire reaches the rear frame opening, bend the end of the provided spline bolt leader to make an eyelet, and attach the fish wire to the leader.

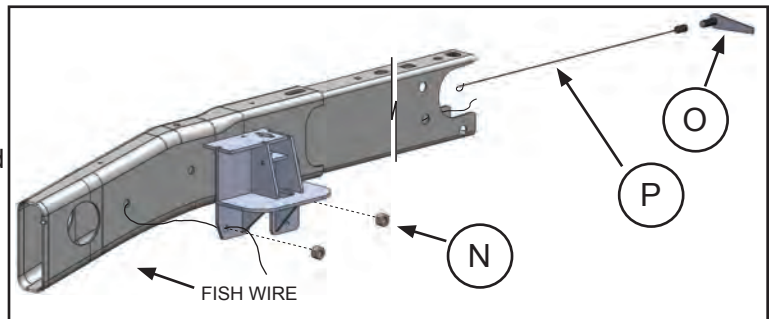

**INSTALLATION TIP:** Prior to threading the anti-rotation bolt into the leader, thread the 1/2" flange nut on and off the bolt to assure that the nut will fit easily once the bolt is in place.

4. Thread an anti-rotation bolt into the provided spline bolt leader and pull it through the frame toward the Front Mounting Bracket and insert it through the existing hole in the frame.
5. Once the anti-rotation bolt is seated in place, fasten using a 1/2" Serrated Flange Nut.
6. Install the remaining anti-rotation bolts in the same manner.

**NOTE:** When running the "fish" wire through the passenger side frame be careful to avoid running the wire over the top of the muffler brackets. The muffler brackets are rods that run through the frame rail and are welded in place. If the "fish" wire is run over the top of these rods the anti-rotation bolts will not pass over them. Remove axle jounce bumpers (two wheel drive trucks only).

# INSTALLATION

## REAR MOUNTING BRACKET INSTALLATION

1. Install the rear mounting brackets onto the frame as you did on page 12, using all the required hardware (see illustration). Finger tighten only.

**NOTE:** There is a flat side to the rear frame spacer {K}. This prevents the spacer from turning in the obround frame hole during installation. Insert the flat side of the spacer parallel to the side of the obround hole in the truck frame as seen to the right.

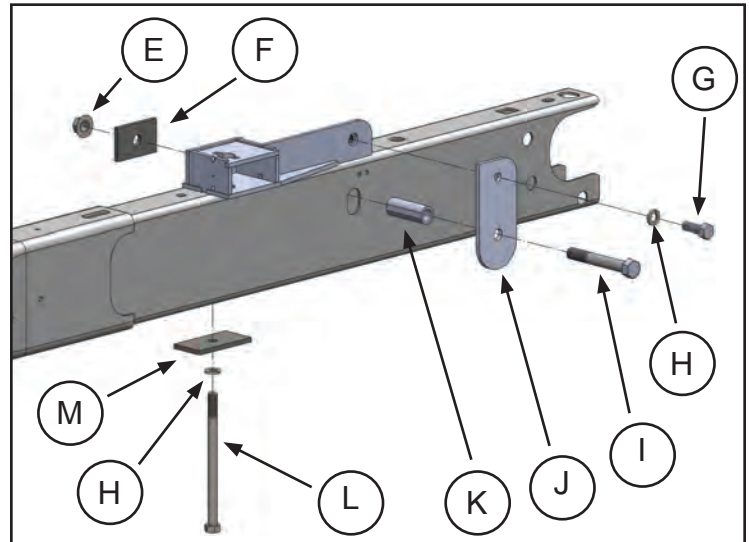

## PART 3: HITCH ALIGNMENT

1. Remove the Super 5<sup>th</sup> hitch from the shipping carton.
2. Secure the base rail extensions to the base rails, leaving the base rail extensions loose to allow lateral movement as you place the rail assembly over the mounting posts (see the illustration to the right).

**NOTE:** The base rail extensions should be installed with the obround hole (found on the bottom plate of the base rail extension) facing down toward the truck bed, and the round hole facing up.

3. Center the base rails between the mounting posts. Finger tighten the base rail mounting bolts.
4. Set the Super 5<sup>th</sup> hitch on the base rails and align the hitch assembly with the mounting holes.
5. Install the hitch pins from the inside. Then install the pin clips, to secure the hitch assembly to the base rails. Use a drift pin to aid your hole alignment.

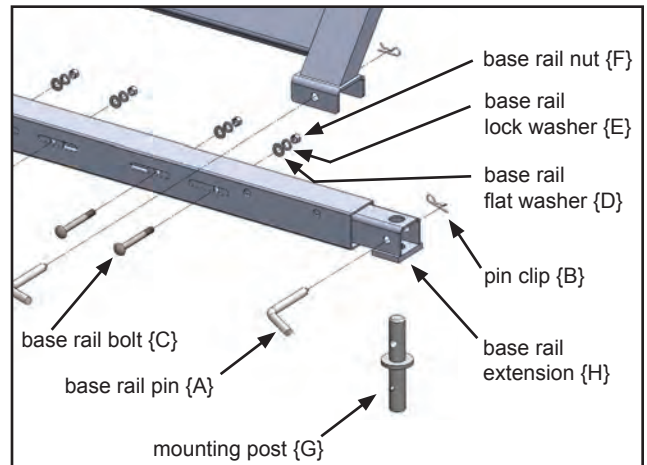

## PART 4: FINAL INSTALLATION PROCEDURES

1. Tighten all bolts, including the base rail bolts, according to the Torque Table below.
2. Remove the hitch and base rail assembly and verify that the mounting posts can be inserted and turned freely without binding. You may need to loosen the bolts on the mounting brackets below if binding occurs. Adjust as needed and retighten the bolts
3. Reinstall the mounting posts, base rails and the Super 5<sup>th</sup> hitch assembly until the assembly can be removed freely without binding.

### TORQUE TABLE

3/8" bolt	—	31 ft. lbs.
1/2" bolt	—	75 ft. lbs.
5/8" bolt	—	151 ft. lbs.
3/4" bolt	—	266 ft. lbs.



*MANUFACTURED BY:*  
PULLIAM ENTERPRISES, INC.  
13790 East Jefferson Blvd.  
Mishawaka, IN 46545  
(574) 259-1520 • (800) 443-2307  
info@pullrite.com • www.pullrite.com