



CHEVY

SuperRail Mounting Kit

#0847



#1200 Super 5th
(16K)

Gross Trailer Weight (Maximum)	16,000 lbs.
Vertical Load Weight (Max. Pin Weight)	4,000 lbs.



#0800 Super 5th
(20.5K)

Gross Trailer Weight (Maximum)	20,500 lbs.
Vertical Load Weight (Max. Pin Weight)	5,125 lbs.

Installation Instructions

SPECIFICATIONS

- Fits 2011-2015 Chevy 2500 & 3500 HD
 - Hitch is located center of the axle
- Custom Mounting Bracket Kit (*Bracket & Hardware*) #0857

TABLE OF CONTENTS

PLATE ASSEMBLY.....	3
#1200 HITCH ASSEMBLY — EXPLODED VIEW	4
#1200 HITCH ASSEMBLY & PARTS LIST	5
#0800 HITCH ASSEMBLY — EXPLODED VIEW	6
#0800 HITCH ASSEMBLY & PARTS LIST	7
MOUNTING KIT PARTS LIST	8
BASE RAIL ASSEMBLY PARTS LIST	9
TRUCK PREPARATION.....	10
MARKING THE TRUCK BED FOR DRILLING.....	10
LAYOUT METHOD	10
TEMPLATE METHOD	11
INSTALLATION	12
PART 1 — BRACKET PLACEMENT & BED HOLE LOCATIONS.....	12
PART 2 — BRACKET INSTALLATION	13
PART 3 — MOUNTING POST INSTALLATION.....	14
PART 4 — HITCH ALIGNMENT	14
PART 5 — FINAL INSTALLATION PROCEDURES	14

PLATE ASSEMBLY

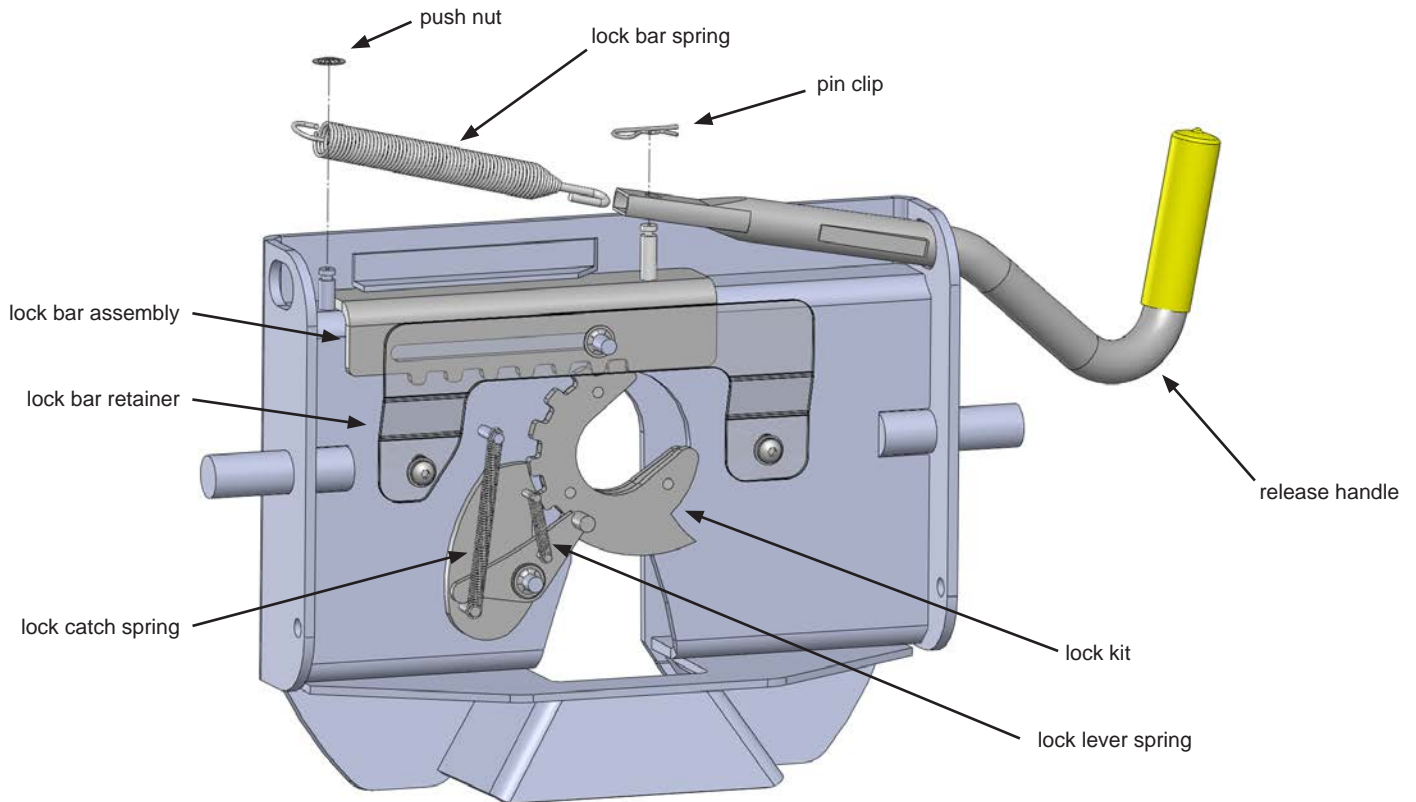

1. Remove the Fifth Wheel Plate from the Rocker Arm and place it upside down on a smooth, clean surface.
2. Insert the Release Handle into the obround hole of the plate as seen above.
3. The Lock Bar Spring must be placed inside the handle prior to placing the handle down over the pin of the Lock Bar Assembly, “catching” the hook inside the handle around the pin.
4. Push the handle and spring assembly down past the groove in the pin of the Lock Bar Assembly, and place the Pin Clip in the groove of the pin to fasten.
5. Grip the body of the spring and stretch it far enough over the opposite pin (welded to the plate) and push it down past the groove.
6. Install the Push Nut to secure the Lock Bar Spring onto the welded pin.

As a PullRite fifth wheel hitch owner, it is important for you to study and manually operate the Fifth Wheel Plate and Release Handle to better understand the locking action. A better working knowledge of the plate will help prevent accidental dropping of your trailer due to incorrect hitching.

Also, it is imperative that you study and adhere to the Maintenance procedures provided in the Owners Manual. If you did not receive one upon purchase, please contact PullRite or visit us on the web at www.pullrite.com.

#1200 HITCH ASSEMBLY — EXPLODED VIEW

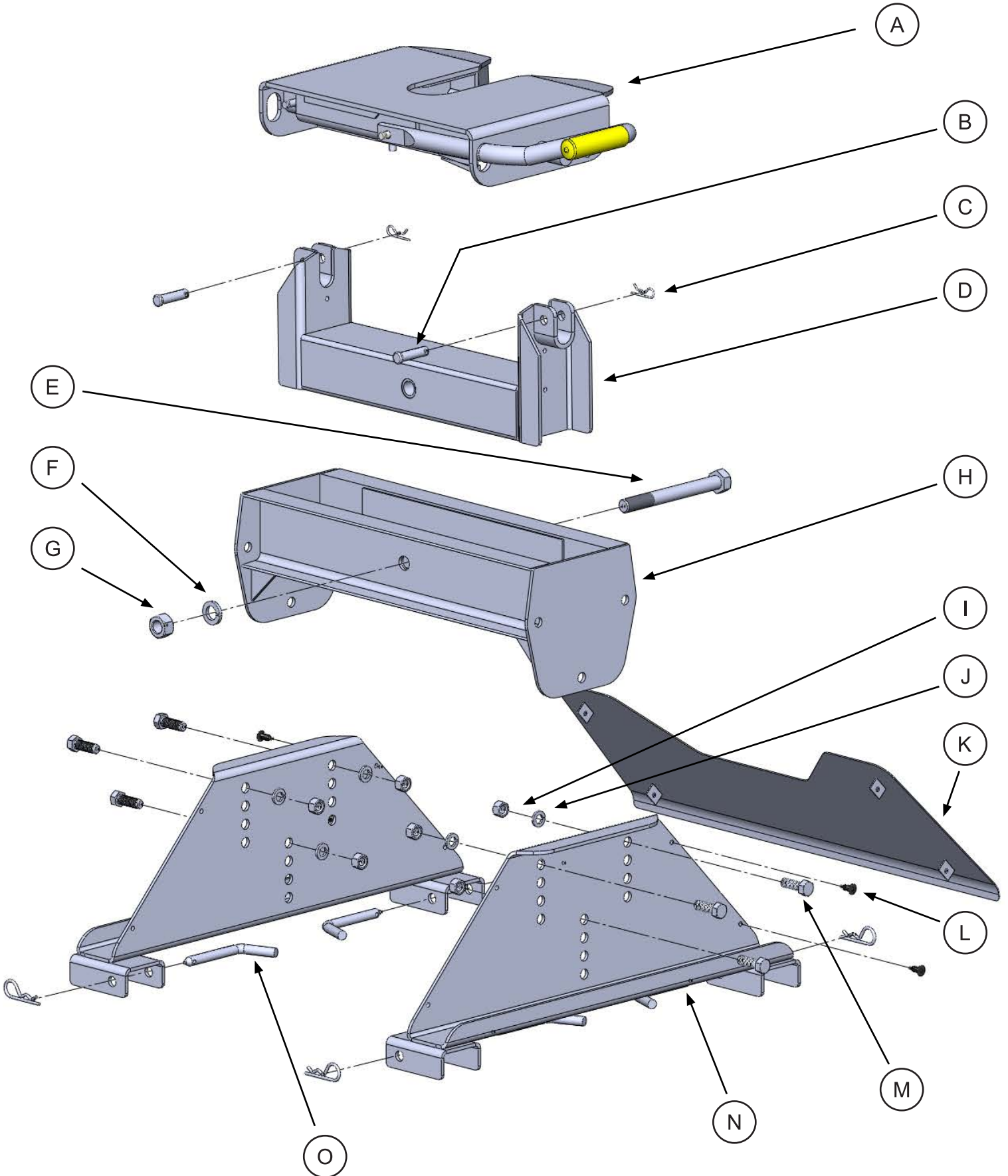

#1200 HITCH ASSEMBLY & PARTS LIST

1. Check part quantities using the Parts List.
2. Arrange the Base Rails parallel to each other and attach the Base Sides using the four 1/2" Base Rail Pins and four Pin Clips.
3. Remove the 3/4" x 7" Rocker Arm Pivot Bolt from the Rocker Arm and Crossmember. The Rocker Arm is shipped upside down in the Crossmember for better packaging and will need to be removed and reinstalled right side up in the Crossmember. Tighten the 3/4" x 7" Rocker Arm Pivot Bolt only enough so that the Rocker Arm will rotate stiffly. Lubricate the Rocker Arm Pivot Bolt with heavy grease before installing.
4. Fasten the Crossmember and Base Sides together using six each of the 1/2"-13 x 1 1/2" Bolts, 1/2" Lock Washers, and 1/2"-13 Hex Nuts. This hitch has four height settings; make certain to adjust the Rocker Arm Crossmember according to your truck and vehicle so you have a minimum of 6" between the top of the truck's bed sides and the bottom of your trailer. Attach the Base Cover Assembly to the Base Sides using the four Plastic Barbed Fasteners provided. The tabs welded to the Base Cover Assembly fit on the inside of the Base Sides. Tighten bolts to 75 foot pounds.

HITCH ASSEMBLY PARTS LIST

item	description	part no.	qty.	material
A	FIFTH WHEEL PLATE	3601	1	
B	CLEVIS PIN	98410111	2	
C	PIN CLIP	98410127	6	#3 PIN CLIP
D	ROCKER ARM	0802	1	
E	ROCKER ARM PIVOT BOLT	98010147	1	
F	ROCKER ARM LOCK WASHER	98200124	1	3/4" SPLIT LOCK WASHER
G	ROCKER ARM HEX NUT	98150131	1	3/4" - 10 HEX NUT
H	ROCKER ARM CROSSMEMBER	1202	1	
I	1/2" HEX NUT	98150153	6	1/2" - 13 HEX NUT
J	1/2" LOCK WASHER	98200142	6	1/2" LOCKWASHER
K	BASE COVER	120302	1	
L	PLASTIC BARBED FASTENER	98410560	4	
M	1/2" X 1-1/2" FRAME BOLT	98010167	6	1/2" - 13 X 1-1/2" HHCS GRD 5
N	BASE SIDE	120301	2	
O	BASE RAIL PINS	08060001	4	1/2" ROUND

#0800 HITCH ASSEMBLY — EXPLODED VIEW

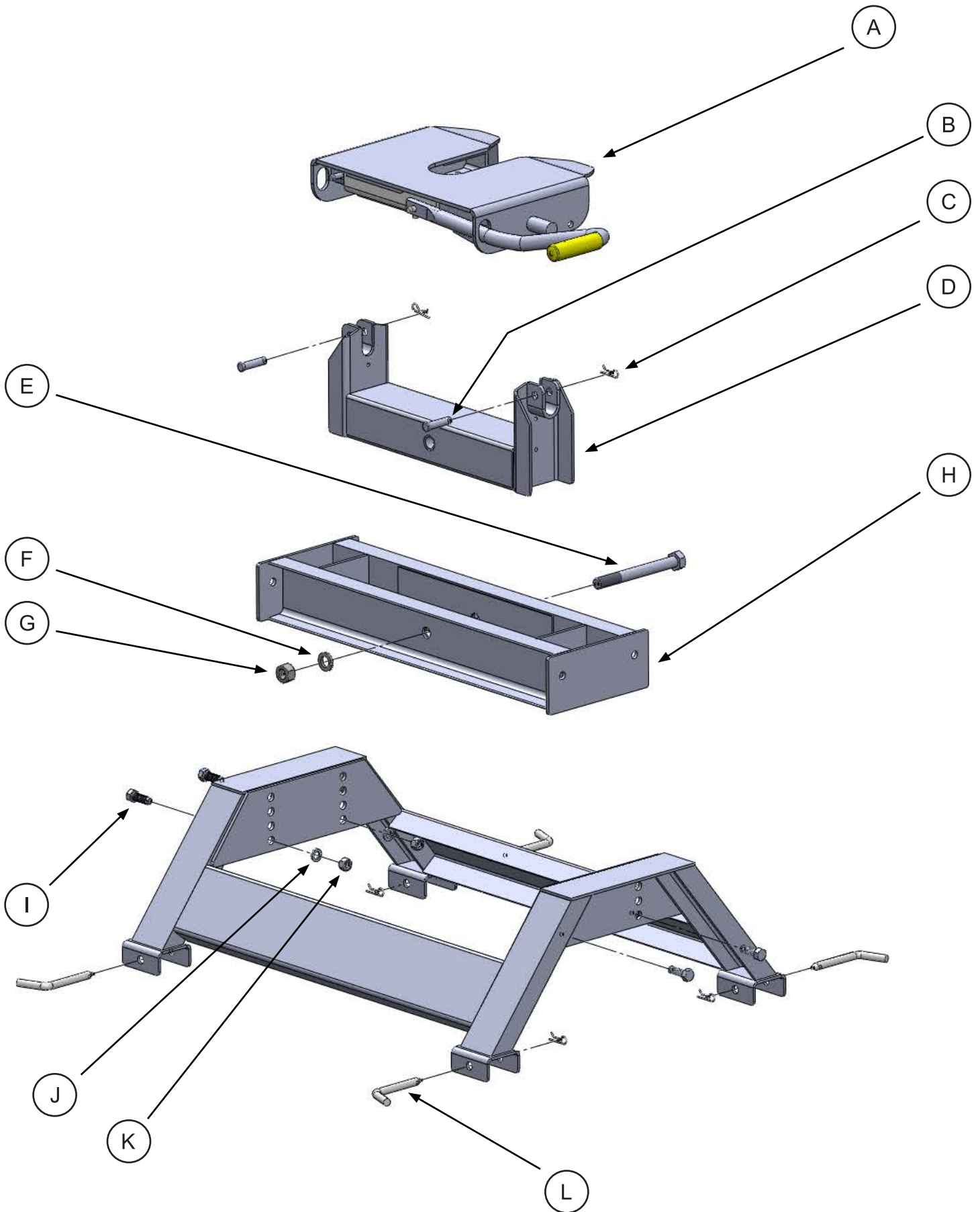

#0800 HITCH ASSEMBLY & PARTS LIST

If the hitch type to be installed is a 20,500 (Part #0800), there is no assembly required except to attach the Base Rails to the base feet of the hitch Base using the four 1/2" Base Rail Pins and four Pin Clips.

This hitch has four height settings; make certain to adjust the Rocker Arm Crossmember according to your truck and vehicle so you have a minimum of 6" between the top of the truck's bed sides and the bottom of your trailer. Be sure to torque all four 1/2" x 1 1/2" Bolts to 75 foot pounds.

HITCH ASSEMBLY PARTS LIST				
item	description	part no.	qty.	material
A	FIFTH WHEEL PLATE	3601	1	
B	CLEVIS PIN	98410111	2	
C	PIN CLIP	98410127	6	#3 PIN CLIP
D	ROCKER ARM	0802	1	
E	ROCKER ARM PIVOT BOLT	98010147	1	
F	ROCKER ARM LOCK WASHER	98200124	1	3/4" SPLIT LOCK WASHER
G	ROCKER ARM HEX NUT	98150131	1	3/4" - 10 HEX NUT
H	ROCKER ARM CROSSMEMBER	0803	1	
I	1/2" BASE BOLT	98010167	4	1/2" - 13 X 1-1/2" HHCS GRD 5
J	1/2" BASE LOCK WASHER	98200142	4	
K	1/2" BASE HEX NUT	98150153	4	1/2" - 13
L	BASE RAIL PINS	08060001	4	1/2" ROUND

MOUNTING KIT PARTS LIST

#0857 CUSTOM MOUNTING KIT

item	description	part no.	qty.	material
A	PASSENGER SIDE BRACKET	085702	1	(SEPARATE FROM HARDWARE KIT)
B	DRIVER SIDE BRACKET	085701	1	(SEPARATE FROM HARDWARE KIT)
	MOUNTING BRACKET HARDWARE KIT	085703	1	(SEE KIT CONTENTS BELOW)

#085703 — MOUNTING BRACKET HARDWARE KIT

item	description	part no.	qty.	material
C	1/2" FRAME BOLTS	98010167	8	1/2"-13 X 1-1/2" HHCS GRD 5
D	1/2" FLANGE NUT	98150201	8	1/2" - 13 SERRATED FLANGE NUT
E	5/8" ANTI-ROTATION BOLT	442704	4	5/8" BOLT W/ WELDED ARM
F	5/8" FLANGE NUT	98150200	4	5/8" - 11 SERRATED FLANGE NUT
G	5/8" BOLT LEADER	98340198	1	5/8" - 11 BOLT LEADER

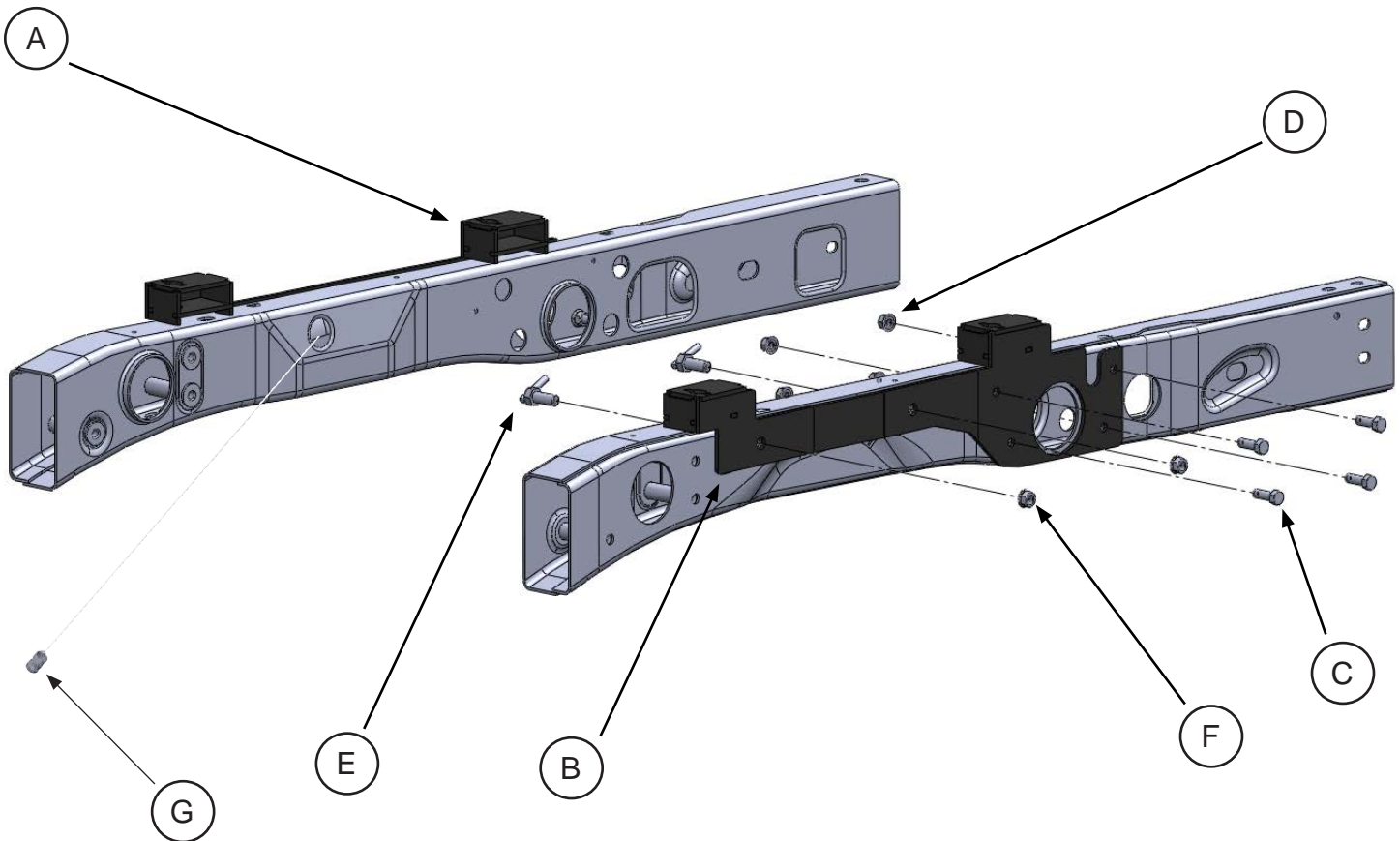

BASE RAIL ASSEMBLY PARTS LIST

#084003 — MOUNTING BRACKET HARDWARE KIT

item	description	part no.	qty.	material
A1	BASE RAIL PIN	08060001	4	BASE RAIL PIN
B1	COTTER PIN	98410127	4	#3 COTTER PIN
C1	BASE RAIL BOLT	98050140	8	3/8"-16 X 3 1/2" CARRIAGE GRD. 5
D1	BASE RAIL FLAT WASHER	98250175	8	3/8" FLAT WASHER
E1	BASE RAIL LOCK WASHER	98200151	8	3/8" LOCK WASHER
F1	BASE RAIL HEX NUT	98150211	8	3/8" - 16 HEX NUT
G1	BASE RAIL MOUNTING POSTS	330701	4	

#0840 — BASE RAIL ASSEMBLY KIT

item	description	part no.	qty.	material
H1	BASE RAIL EXTENSION	084002	4	
I1	BASE RAIL	084001	2	

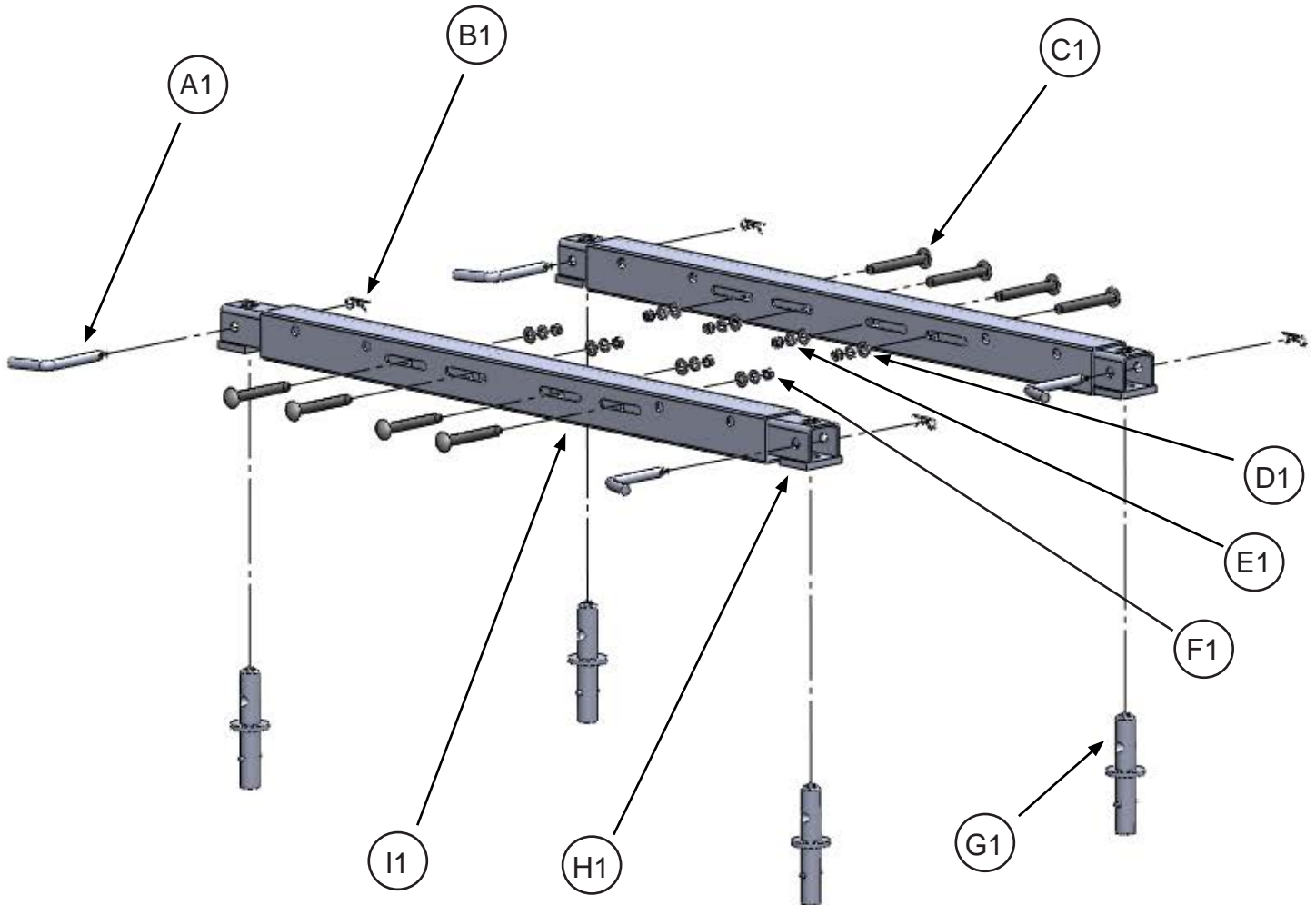

TRUCK PREPARATION

1. Block vehicle wheels. Some vehicles may require you to raise the rear of the truck in order to make it easier to drill for installing the mounting brackets on the truck frame.
2. Remove the spare tire and set aside.
3. You may wish to remove the wheels to give yourself greater working room.
4. Remove the top bolt of the shock absorber bracket on the driver's side, and compress the shock, moving it rearward behind the frame tube.

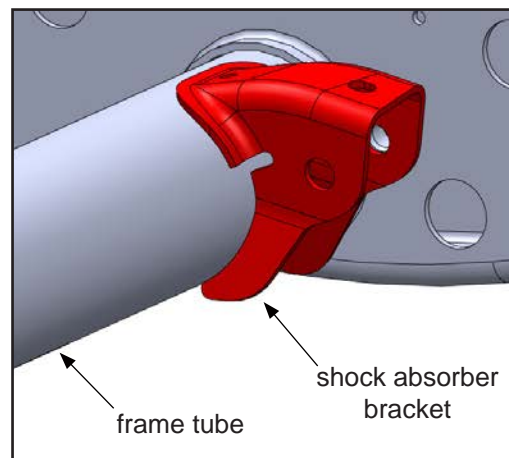

MARKING THE TRUCK BED FOR DRILLING

LAYOUT METHOD

If you purchased an installation template, please proceed to "TEMPLATE METHOD". *Templates are sold separately.*

1. Referencing "Truck Bed Dimension Table" below, measure and mark from the back of the bed forward, the values for "A" and "B". Do this at any point on both sides of the bed.
2. Draw a line across the bed from mark to mark.
3. Find the centerline of the bed.
4. Draw a line down the middle of the bed from front-to-rear.

Center the measurement of "C" across the centerline at the front-most line you made in step 2 and mark the measurement on each side (parallel to the centerline).

5. Center the measurement of "D" for the rear most line made in step 2, and again mark the measurement on each side (parallel to the centerline). This will locate the 4 drill holes.

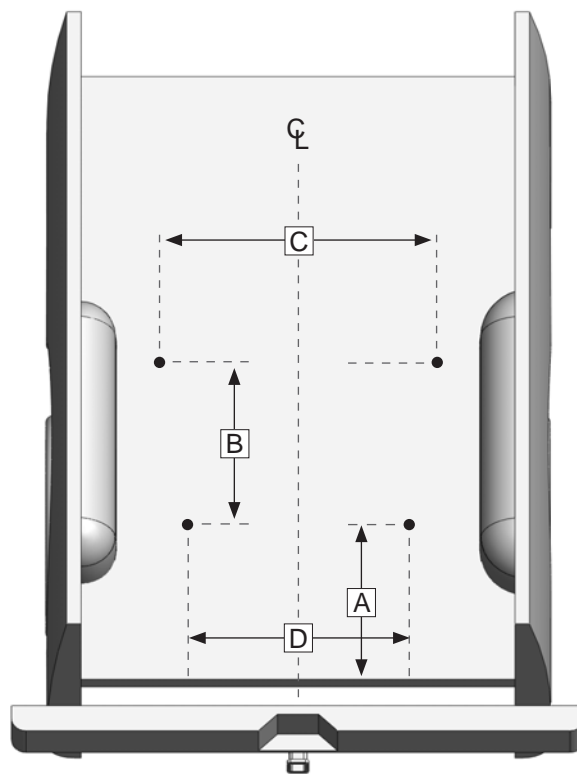

TRUCK BED DIMENSION TABLE

BED LENGTH	LAYOUT METHOD				TEMPLATE METHOD	
	"A"	"B"	"C"	"D"	"X"	Template part#
6 ft.	26-1/4"	24"	41-1/4"	39-9/16"	25-1/4"	08570000
8 ft.	31-5/16"	24"	41-1/4"	39-9/16"	30-5/16"	08570000

TEMPLATE METHOD

1. Lay the template in the truck bed, centering it from side-to-side, and parallel to the end of the truck bed using the dimension "X" listed in "Truck Bed Dimension Table."
2. Mark the 4 holes, while making sure the template does not move.

NOTE: The **TEMPLATE** should be orientated as shown in the drawing to the left. Notice that the spacing of the forward and rearward facing holes may be different, and can be used to determine the correct orientation of the template. Item "C" in the "Truck Bed Dimension Table" shows the forward facing dimension, and Item "D", the rearward facing dimension. Note also, the information etched into the template — the direction of the cab, the template number and the revision date.

INSTALLATION TIP: The template has a tendency to move when placed on the slick paint of new truck beds, and it may be helpful to place a small piece of **NON-SKID** matting, such as "SCOOT-GARD"™ or simply use duct tape on each corner to help keep the template from moving.

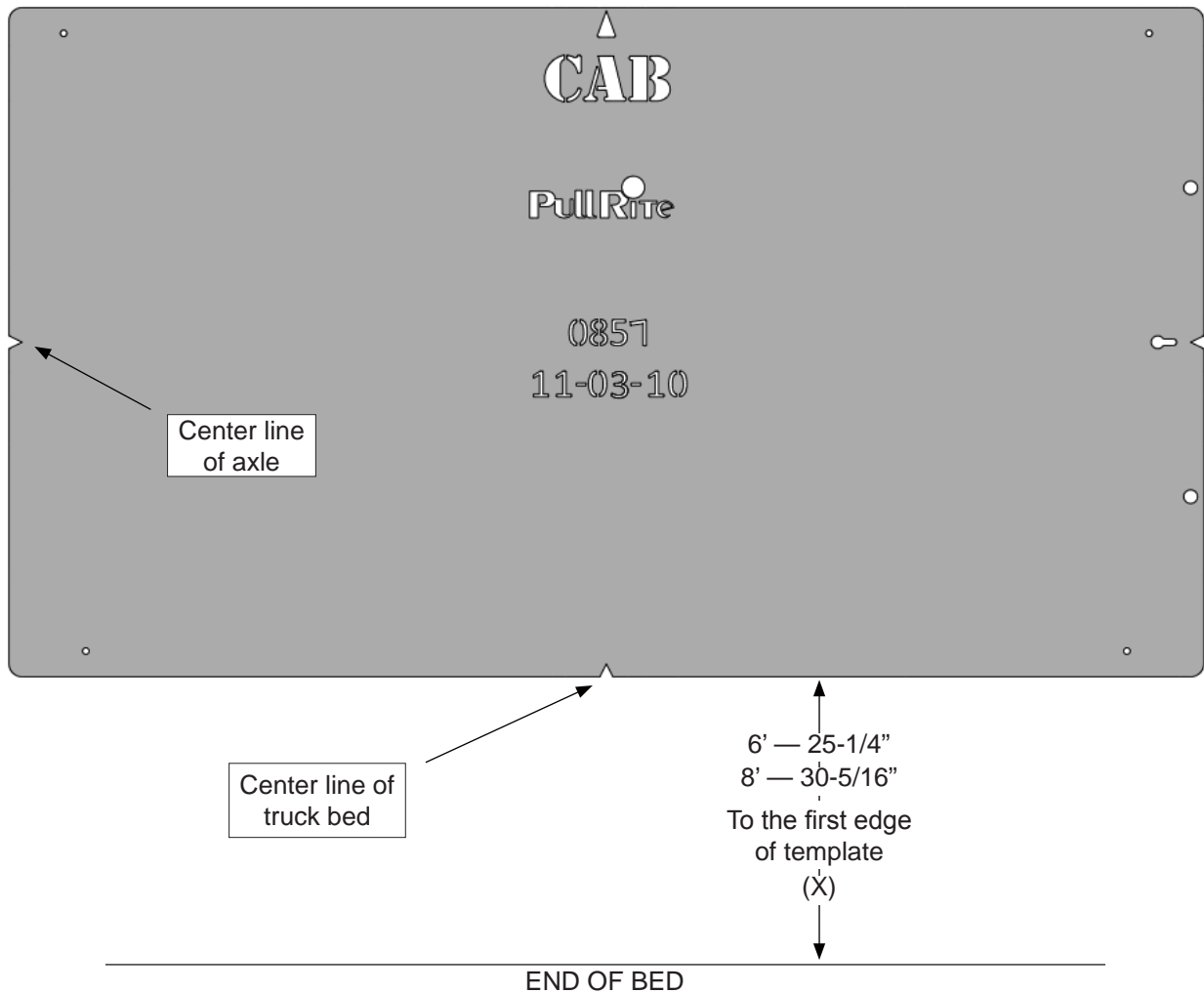

INSTALLATION

PART 1 — BRACKET PLACEMENT & BED HOLE LOCATIONS

Since most truck beds are not installed square to the frame or are the same distance from the back of the cab, the installer will need to make sure the bed holes line up properly with the center of each mounting bolt hole.

The basic steps in this section are as follows:

- Layout the bed holes
- Drill the first pilot hole in the bed
- Check centering
- Adjust the bed hole layout if necessary
- Drill the second pilot hole and check centering to ensure bed hole locations are square to the frame; adjust as needed
- Drill remaining pilot holes in the bed; check centering

Detailed Installation Instructions

1. This is a no-drill installation, both brackets will use existing holes in the frame drilled by the manufacturer (note drawings for existing holes and fastening methods below and on the following page).
2. Use transparent tape to cover the mounting post hole on the top of each mounting bracket (when the pilot hole is drilled through the bed, the tape will be pierced by the small drill; it should be positioned in the center of the 1" mounting post hole).
3. Position all mounting brackets on the frame and clamp or fasten in place to determine if your bed layout marks are square to the frame, making sure the brackets are tight against the frame (some mounting brackets may have a slight warp due to the metal characteristics during the welding process). Do not tighten fasteners permanently, you will be removing the brackets to drill the 2" holes through the bed.

WARNING: Prior to drilling any holes, be sure to check the inside of the frame to guard against drilling into the fuel tank, wiring, brake lines or fuel module.

NOTE: If the truck has overload brackets, remove and install the Mounting Brackets on the frame, then reinstall the overload brackets using the provided 1/2" x 1-1/2" bolts.

4. Drill the first 1/16" pilot hole through the truck bed over the rear hole of the Driver Side Mounting Bracket where you made the mark during the "Marking Bed for Drilling." The bit should come down through the 1" mounting post hole, piercing the transparent tape, aiding the centering of the bracket front-to-rear and side-to-side.
5. If the pilot hole is off center to the 1" mounting post hole, remember to adjust all the pilot hole locations accordingly.

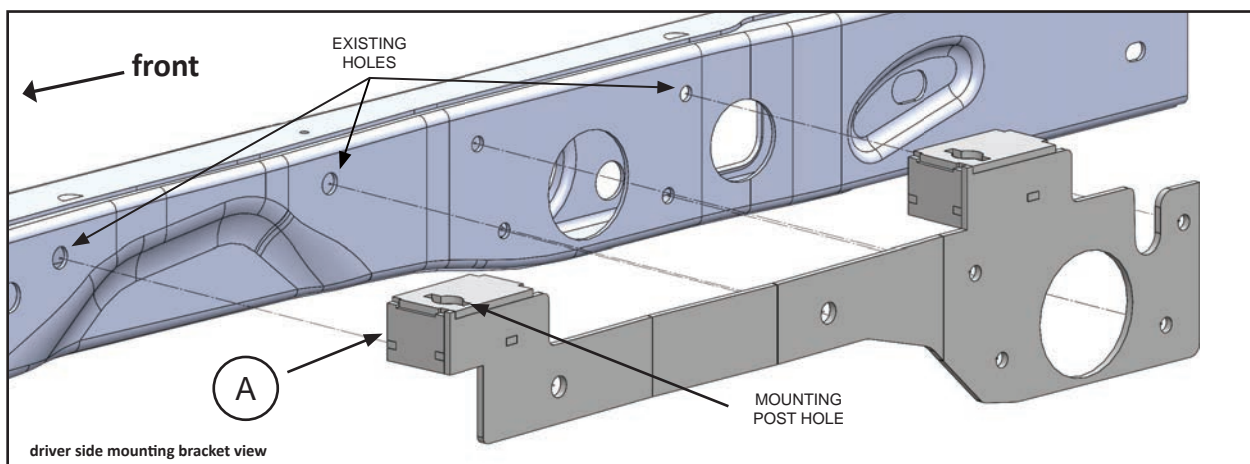

INSTALLATION

NOTE: Some truck beds are not installed square on their frame by the manufacturer. To ensure your pilot holes are aligned properly, it is important that you use the measurements provided only as a starting point and make adjustments as needed. Once you have the first pilot hole centered, you will use this hole as a point of reference for all remaining pilot hole adjustments. If you are using the Template Method, simply use the properly drilled hole as a pivot point to square the remaining holes to the frame. If you are using the Layout Method, you may accomplish the same thing by using a framing square and straight edge.

6. Remove both mounting brackets from the frame (and transparent tape) before drilling the 2" holes.

WARNING: Before proceeding to the next section, you must verify that each pilot hole is centered over the 1" mounting post hole on each bracket before the 2" mounting post holes are drilled through the bed.

7. Remove the mounting brackets, use a 2" hole saw centered over the 1/16" pilot hole and cut the bed for the mounting posts.
8. De-bur inside the holes and use a paint stick to touch up the edges.

PART 2 — BRACKET INSTALLATION

1. Using a clamp, place the driver side mounting bracket over the existing holes in the frame, making sure it is flush with the side of the frame.
2. Install the 1/2 x 1-1/2" bolts {C} to secure the Mounting Brackets to the existing holes in the frame using the 1/2" Flange Nuts {D}.
3. The two forward holes on each mounting bracket requires Anti-rotation bolts {E} to be "fished" through the frame to fasten the 5/8" bolts through the existing holes.
4. Thread an Anti-rotation bolt into the provided Bolt Leader {J}.
5. Fish the Bolt Leader and Anti-rotation Bolt through the large hole located on the back-side of the frame, and out through the 5/8" hole in the frame and bracket on the outside of the frame (see illustration below).

INSTALLATION TIP: Prior to threading the Anti-rotation bolt into the leader, thread the 5/8" Flange Nut {F} on and off the bolt to assure that the nut will fit easily once the bolt is in place.

6. Once the anti-rotation bolt is seated in place, remove the bolt leader and fasten using a 5/8" Flange Nut. Hand tighten only.
7. Install the remaining Anti-rotation bolts in the same manner and repeat the above steps for the Passenger Side Mounting Bracket.

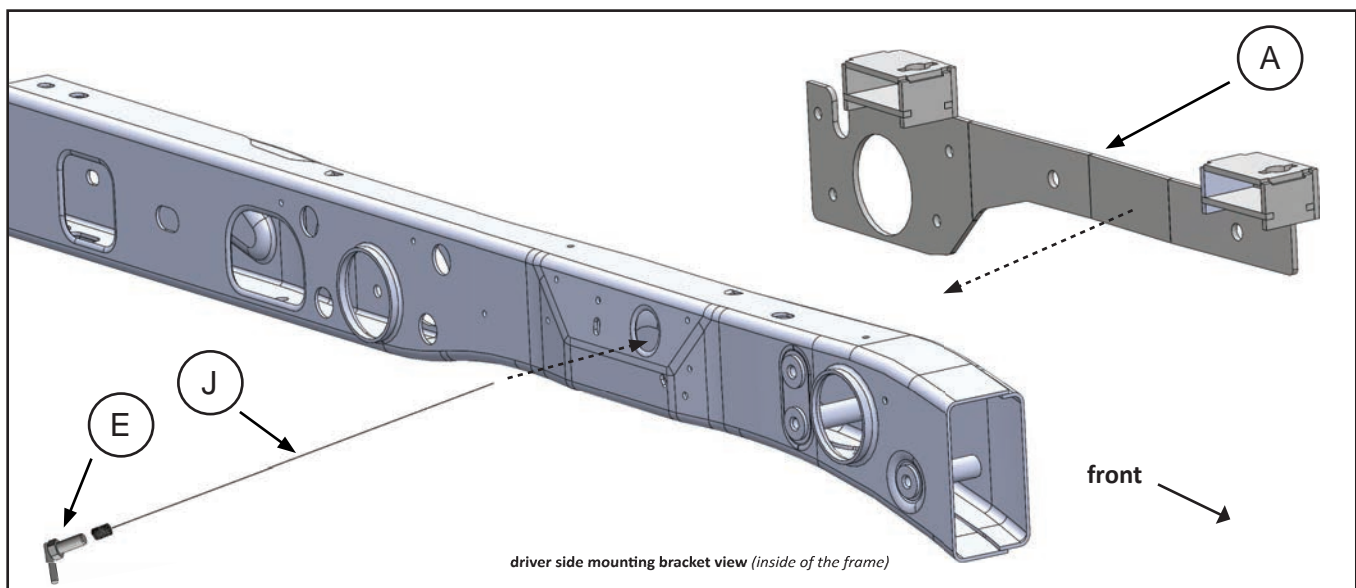

INSTALLATION

PART 3 — MOUNTING POST INSTALLATION

1. Install the mounting posts through the bed into the mounting bracket post holders. Rotate the posts a quarter turn (see the illustration to the right). Four posts are required for installation.

NOTE: Vehicles using plastic bed liners may require taller mounting posts (part# 330705) to seat properly into the post holders.

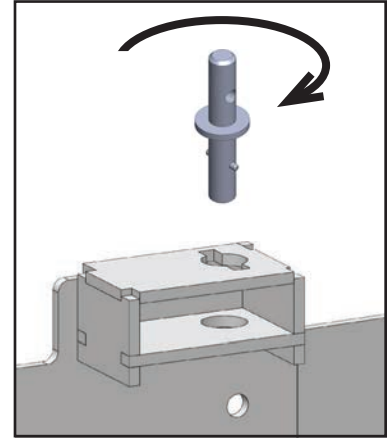

PART 4 — HITCH ALIGNMENT

1. Remove the Super 5th hitch from the shipping carton.
2. Secure the base rail extensions to the base rails, leaving the base rail extensions loose to allow lateral movement as you place the rail assembly over the mounting posts (see the illustration to the right).

NOTE: The base rail extensions should be installed with the obround hole (found on the bottom plate of the base rail extension) facing down toward the truck bed, and the round hole facing up.

3. Center the base rails between the mounting posts. Finger tighten the base rail mounting bolts.
4. Set the Super 5th hitch on the base rails and align the hitch assembly with the mounting holes.
5. Install the hitch pins from the inside. Then install the pin clips, to secure the hitch assembly to the base rails. Use a drift pin to aid your hole alignment.

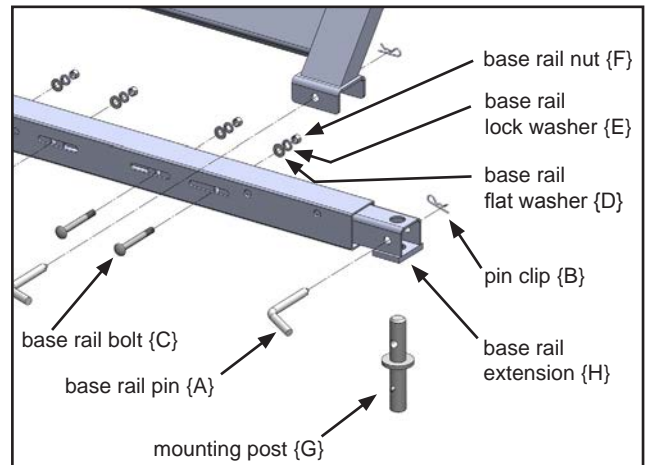

PART 5 — FINAL INSTALLATION PROCEDURES

1. Tighten all bolts, including the base rail bolts, according to the Torque Table below.
2. Remove the hitch and base rail assembly and verify that the mounting posts can be inserted and turned freely without binding. You may need to loosen the bolts on the mounting brackets below if binding occurs. Adjust as needed and retighten the bolts
3. Reinstall the mounting posts, base rails and the Super 5th hitch assembly until the assembly can be removed freely without binding.

TORQUE TABLE

3/8" bolt	— 31 ft. lbs.
1/2" bolt	— 75 ft. lbs.
5/8" bolt	— 151 ft. lbs.
3/4" bolt	— 266 ft. lbs.



MANUFACTURED BY:
PULLIAM ENTERPRISES, INC.
13790 East Jefferson Blvd.
Mishawaka, IN 46545
(574) 259-1520 • (800) 443-2307
info@pullrite.com • www.pullrite.com