



Slip Plate Instructions

REMOVAL OF HITCH COMPONENTS

1. Remove the top plate {A1} of the hitch by pulling the clip {G9} and pin {H2} from either side of the plate (see Figure 1). Set parts aside for reassembly in later steps.
2. At this time, remove any excess lubrication that is presently on the way tubes {D1}, this will reduce the mess when removing the way tubes from the base {F1}.
3. Remove the four 1/2" bolts {H11} that fasten the way tubes to the base of the hitch. Retain the bolts and flange nuts {H12} (see Figure 2).
4. Pull both way tubes from the forward bulkhead by pulling them both toward the rear (tailgate end) of the hitch enough to where they are free from the front end (see Figure 2).
5. Remove the nylon stop block {E1} from between the way tubes and set aside (see Figure 3).
6. Remove the way tubes completely from the base.
7. Remove the rocker arm {B1} and cam arm {C1} assembly from the base of the hitch.

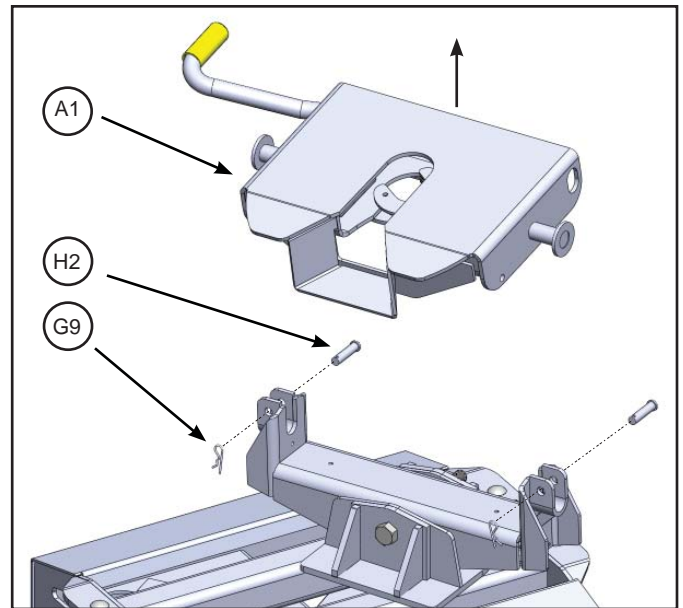

Figure 1

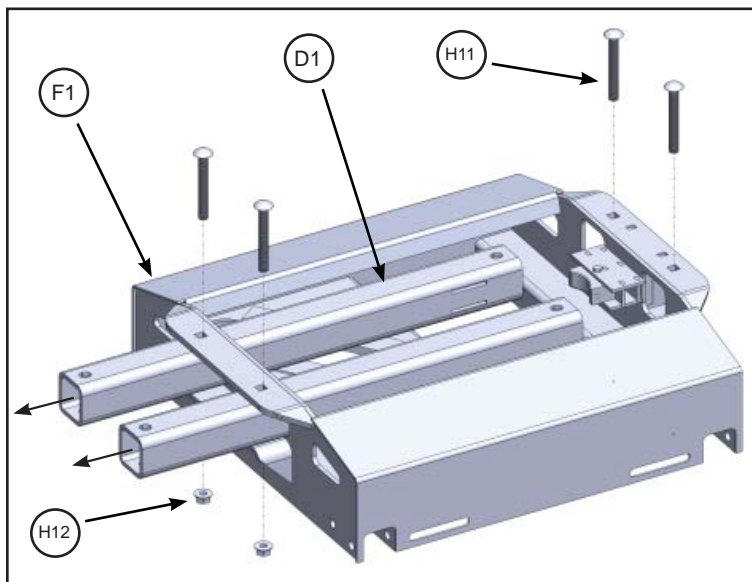

Figure 2

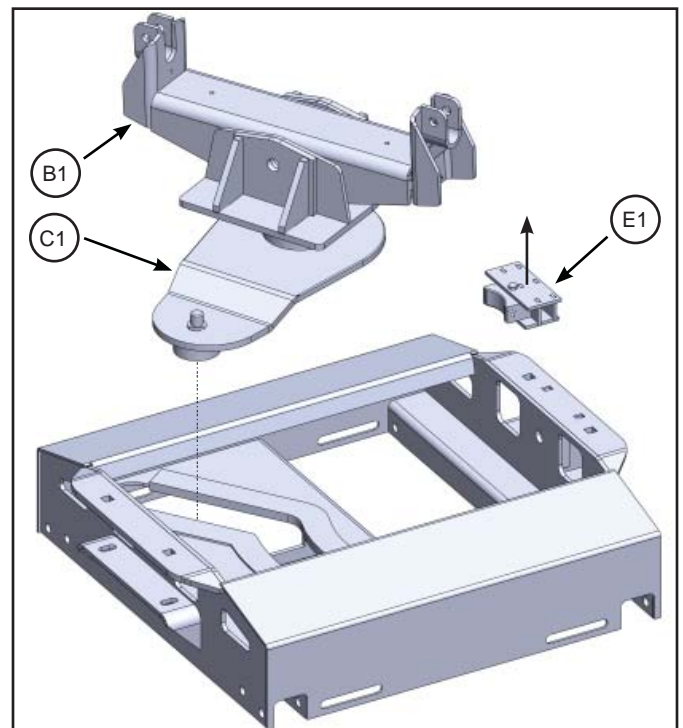

Figure 3

PREPARING THE WAY TUBES AND CAM ARM FOR APPLICATION

1. Clean any old lubrication from both way tubes {D1} and the cam arm {C1}, using a degreasing product (e.g., WD-40, automotive brake cleaner or paint thinner)
2. Lightly file any imperfections that you can feel above the surface of the metal.
3. Lightly sand all four sides of the way tubes -- this will help “rough up” the surface, allowing the Slip Plate to adhere to the metal surface more effectively.
4. You will want to follow the same steps for the portions of the cam arm that make contact with the *top and inside surfaces* of the way tubes.

Way Tube Application -- Spray an even coating of the Slip Plate on the full length of each of the four sides of the way tubes. Allow approximately 15 minutes dry time per side. Repeat for *two* full coats.

Cam Arm Application -- Spray an even coating of Slip Plate on the surfaces of the cam arm that make contact with the way tubes. You will want to put two coats on these surfaces for your first application.

REASSEMBLING THE HITCH

1. Set the cam arm on the base of the hitch so the roller bearing rests in the center portion of the cam slot.
2. Slide the way tubes through the rearward holes in the base in the same manner they were removed. Position them so the way tubes sit between the upper and lower portion of the cam arm.
3. Reinstall the nylon stop block between the way tubes.
4. Slide the way tubes into the forward bulkhead.
5. Fasten the way tubes to the base of the hitch using the four 1/2” bolts and flange nuts.

MAINTENANCE USING SLIP PLATE

It is necessary to inspect the way tubes before you begin each trip. Apply a liberal coating of Slip Plate. On a daily basis, while towing, you will need to inspect the full length of the way tubes to see if you need to reapply the Slip Plate.



MANUFACTURED BY:
PULLIAM ENTERPRISES, INC.
13790 East Jefferson Blvd.
Mishawaka, IN 46545
(574) 259-1520 • (800) 443-2307
info@pullrite.com • www.pullrite.com